

ORCHARD HILLS-MAPLEWOOD HOMEOWNERS ASSOCIATION

www.ohmha.org

OHMHA NEWSLETTER

May 2013

What's New and Exciting with Ann Arbor Transit Authority?

***Find out
Friday, May 31, at 7:30 pm
at Thurston School Teachers' Lounge***

Join your neighbors on the evening of **Friday, May 31** for the OHMHA Annual Meeting and Election, starting at **7:00 pm**. At **7:30 pm** there will be a presentation you won't want to miss from Chris White, AATA manager of service development.



Chris White of AATA will be the OHMHA Annual Meeting Speaker on Friday, May 31 at the Thurston School Teachers' Lounge.

2013 Annual Neighborhood **Garage Sale!**

Saturday, May 18, from 9 am

OHMHA will run ads and will post signs at subdivision entrances and major intersections. All you have to do is set up your sale and enjoy the day!

Inside this Issue:

Landscaping, pg 2

Snow Plowing & More, pg 3

Refuse Containers, pg 3

Solar Panels, pg 4

Safe Routes to School, pg 5

Swimming Pool News, pg 6

Budget & Elections, pg 6-7

Coming soon: New Landscaping at the Plymouth Road and Georgetown Boulevard Entrance

- by Jack Cederquist and Lindsay Hanna

Having an attractive entrance at Plymouth Road is important to all Orchard Hills and Maplewood residents. For many years, the entrance featured a distinctive carriage. More recently, a colorful presentation was installed and maintained by residents Karen Land and Jack Cederquist. To renew the look of the entrance once again, the OHMHA Board has contracted with Lindsay Hanna, a recent master's degree graduate of the University of Michigan's School of Natural Resources, to design and install a new planting. This renewal uses Association funds from the 2012/2013 budget. The OHMHA Board also proposes that 2013/2014 funds be budgeted for a limited amount of summer watering and weeding to keep the new entrance looking great!

Lindsay's design uses some of the existing plants but also adds new native species. She has taken care to choose plants which can survive the harsh environment of the entrance with a minimum of attention. The garden will include the following (from near Plymouth Rd back toward Orchard Hills):

Sedum Sedum kamstachaticum and Spreading Thyme Thymus: These low-lying, fast-spreading plants will be placed in the snow plow zone of the garden. They are hardy and don't mind a little trampling.

Spreading Juniper Juniperus horizontalis and Penstemon Penstemon 'Dark Towers': These two types of plants are currently in the garden. The Juniper adds all-season greenery while the dark purple flower "towers" on the Penstemon are striking later in the season!

Catmint Nepeta sp. and Black-eyed Susan Rudbeckia hirta: Catmint is a hearty clumping plant. It has silvery green leaves and is covered in pale purple flowers in the summer. Black-eyed Susans are a tough native that love to spread. Their golden blooms will fill in between the catmint.

Autumn joy Stonecrop Sedum 'Autumn Joy': A larger sedum, these plants will border the whole garden with their pale green leaves and striking red flowers.

Oakleaf Hydrangea Hydrangea quercifolia: To add a little height to the garden, native hydrangeas will be put in near the sign. Dark green foliage and white flowers bloom in the summer and leave papery tan husks that add pretty winter texture. ■

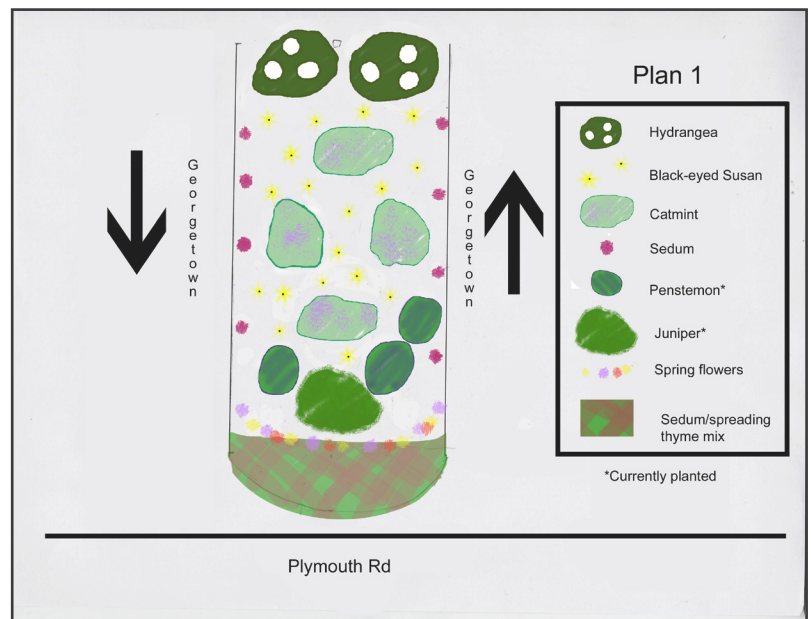

Neighbors Get the Inside Scoop on City Services

- by *Peter Mooney*

On March 12, 2013 Ann Arbor City Administrator Steve Powers spoke to the OHMHA board and about 20 guests. Powers has served in his current role since late 2011, serving previously in Marquette.

Water Main Replacement, Snow Plowing and More

Among the issues he addressed was a Yellowstone Drive water main replacement project scheduled for 2014-15. Powers indicated that the schedule is for design to be completed in the fall/winter of 2013 and for construction to begin in the spring of 2014. The project will replace pipes on part of Yellowstone, between the two Bluett intersections.

Powers also addressed concerns about the frequency and quality of snow plowing. Residents indicated that during recent storms plows were slow to arrive and at times blocked cars in. Powers indicated that he would have appropriate staff contact the residents who expressed concerns.



City Administrator Steve Powers speaks to the Neighbors in March 2013.

Solid Waste News

Also attending the meeting was Ann Arbor's Solid Waste Coordinator, Tom McMurtrie. McMurtrie discussed a possible reduction of the trash pickup schedule to once every two weeks. He explained, however, that recyclables would still be picked up every week and that food waste could be included in the weekly compost pickup. No decision has been made on this proposal.■

Friendly Reminders on Refuse Containers

Here's a friendly reminder about guidelines concerning refuse containers, from the City's website:

Residential refuse, recycling, and compost containers must be placed at the curb or designated collection site by 7 a.m. on the weekly collection day.

- Leave at least 3 feet between each category of materials set out for recycling, refuse and compostable collection, if possible.
- Disabled residents may request side door refuse and recycling collection service by contacting the Customer Service Center at 994-2807.
- Solid waste containers must be stored at the **side or rear** of the dwelling and not placed at the curb more than 24 hours ahead of time. Empty containers must be removed from the curb within 12 hours of service. ■



An appropriate place to store refuse containers is at the side or rear of the dwelling, according to guidelines on the City's website.

Solar Panels on Plymouth Road

- by David Bizot

The installation of solar panels on the University of Michigan's North Campus Research Complex (NCRC) over the winter generated a wide range of reactions from neighborhood residents. Independent of the project's merits as a source of alternative energy, the OHMHA board received numerous complaints about the process by which this installation occurred. These concerns could be summarized as follows:

- The appearance of the project came as a surprise
- The university failed to seek public review or input on the project
- The panels appear to have substantially altered the character of the segment of Plymouth Road where they are located.

Responding to residents' concerns, the board took up the issue at its regularly scheduled January 8, 2013 meeting and passed a resolution which called for, in general:

- The university to halt further construction until public input had been sought and any concerns addressed;
- The project to be changed or mitigated in such a way to improve the aesthetics from Plymouth Road; and
- The university to seek public input when planning future development on the NCRC.

The complete text of the resolution can be found on the OHMHA website.

In part due to the board's engagement, the university hosted a meeting on February 1, 2013 to discuss these and other concerns. Besides an OHMHA representative, attendees included city planning staff, DTE technical personnel, and Ward 2 representatives Jane Lumm and Sally Petersen. Director of Community Relations Jim Kosteva and other university staff were present to discuss the project and answer questions. Among the outcomes of this meeting were:

- An acknowledgement by the university that it did an inadequate job in reaching out to the community about this project and a commitment to improve future communication. It was noted that the OHMHA can provide a channel for that outreach through its website, Facebook page, and regular newsletters.
- The existing landscaping plans will be reevaluated to see if more can be done to hide the installation from Plymouth Road (additional landscaping was already planned for this spring).
- Since the project provides power to the electrical grid, rather than a specific facility, the location and scale of the project was driven in part by requirements to be near the DTE trunk lines running under Plymouth Road.
- Since the installation is essentially complete, changes in the location or number of panels would be very expensive and therefore is unlikely.

The OHMHA will continue to monitor the project as the work wraps up this spring. The board hopes that our engagement on this topic will mean that, as future development is planned for the NCRC, the university will be more transparent with its intentions, actively seek input from the community, and respond to any concerns raised by residents. One of the most important roles the OHMHA has is to ensure neighborhood voices are heard. To that end, we encourage residents to communicate concerns about nearby development not only to the board, but directly to the city, university, developer, or ward representative, as appropriate. ■

Safe Routes to School Program

- by *David Bizot*

The city is implementing several pedestrian improvements in or near the neighborhood this year. A 2010 "Safe Routes to Schools" grant (for Thurston Elementary) will fund the following improvements this spring:

- Upgraded crosswalk pavement markings at five intersections and upgrading advance school warning signs at 33 locations within the Thurston neighborhood.
- Constructing two new mid-block crosswalks on Green Road with pedestrian refuge islands north of Sugarbush Park, and a four- to three-lane conversion.
- Installing rectangular rapid-flashing beacons at two locations on Green Road (between the Burbank Drive intersections and at a new mid-block crosswalk north of the Georgetown Boulevard sidewalk extension, after it passes Cedarbrook).



Under the Safe Routes to School program plan, this sidewalk at the north end of Georgetown will lead up to a crosswalk across Green Road.

A separate, September 2012 Safe Routes grant (for Clague Middle School) is tentatively scheduled for construction in late summer/fall of 2013. This work will involve constructing new sidewalks on the east side of Nixon Road and an additional pedestrian island on Green Road. For more information on the Safe Routes to School program, see <http://saferoutesmichigan.org/sr2s> ■

Facebook Helps our Neighborhood Stay in Touch

Want to be the first to hear about city news affecting us, and about cool neighborhood happenings?

We invite you to follow OHMHA on Facebook! Launched in July 2012, the OHMHA Facebook page has 73 followers.

Find us by searching "Orchard Hills Maplewood" on Facebook (or from the OHMHA website at www.ohmha.org).

The most popular post recently (seen by 142 people, apparently it "went viral"), was this at right, posted in early March, showing "snowdrop" flowers springing up, with the snow still around. ■



OHMHA Proposed 2013-2014 Budget

	Budget 2012	Actual 2012	Budget 2013
Balance at Start of Year			
General Balance	8335	8555	8926
Legal Fund	3834	3834	3834
Anita Jones Memorial Fund	1130	1130	245
Total	13299	13519	13004
Anticipated Income			
Interest	5	3	5
Dues & Contributions from FY 2012	370	170	120
Annual Dues and Contributions	3000	2525	2500
Total	3375	2698	2625
Anticipated General Expenses			
Georgetown Entrance	600	176	1270
Grounds Maintenance	500	0	600
Neighborhood Social Events	1500	1078	1500
Newsletter Expenses	1500	292	500
Garage Sale	120	5	120
Organizational Fee	40	30	40
Bank Fees	20	5	5
Website Fees	50	0	50
Donation to Nature center	300	0	600
Liability from previous year	670	432	500
Transfer to Legal Fund	0	0	0
Total	5300	2018	5185
Anticipated Legal Budget			
Legal Expenses	0	0	0
Expenditure from Anita Jones Memorial Fund			
Installation of Memorial Bench	1130	885	0
Balance at Year End			
Operating Fund	6410	8926	6611
Legal Fund	3834	3834	3834
Anita Jones Memorial Fund	0	245	245
Total	10244	13004	10690

Budget Note: This year, the Board will consider funding mechanisms, including a draw-down of our assets, to make significant structural repairs to the Georgetown Entrance wall and cupolas. Stay tuned for more on this subject in the next newsletter. ■

About the OHMHA Elections

HOW:

You are eligible to vote if you have paid your 2012-2013 dues. Not a member but want to vote? Simply pay your 2012-2013 dues and then cast your ballot by June 1. Turn in your ballot at the OHMHA General Meeting (same night as Thurston Ice Cream Social), Friday, May 31, or drop off or mail your ballot to Peter Mooney, 3352 Yellowstone, Ann Arbor, 48105

DUES: After June 1, we will be accepting dues (\$20) for the 2013-14 fiscal year (6/1-5/31).

WHY JOIN OHMHA?

Membership is voluntary, but your dues directly support our neighborhood by financing such projects as entryway landscaping and signage, newsletters, website costs, garage sale publicity, fall festival, maintaining a legal fund, etc. ■

OHAC and Dolfin Pool News for Summer 2013

The Orchard Hills Athletic Club (OHAC) is a separate organization from the Orchard Hills Maplewood Homeowner Association (OHMHA). Pool News is included here as a neighborhood courtesy.

Dreaming of warm weather and lazy days spent poolside? Make those dreams come true for the 2013 summer season by joining Orchard Hills Athletic Club. Relaxation and a quick cool down on a sweltering hot day (remember last summer?!) can be found in your own neighborhood at two conveniently located pools: OHAC (2300 Yorktown) and Dolfin (2050 Prairie). Membership gives you access to both!

The club offers swim, dive and synchronized swim teams (for kids of all ages and abilities), lap lanes, adult swim, swim lessons, grills, picnic tables, volleyball net, social events and private party rentals. Go to www.ohacpool.org for more information and application forms including early registration deadline and available discounts.



Both pools open Memorial Day weekend. If you wish to check out the pools join us at the OPEN HOUSE on Sunday, June 2 from 1-5 pm. Bring your family and friends to either pool and swim for free. Come see why so many people join year after year. **Be a part of the OHAC tradition!** ■

OHMHA 2013 Election Ballot

All residents who are paid members for the 2012-2013 fiscal year are eligible to vote, one vote per household.

BOARD MEMBERS: The following candidates have been nominated for Board membership, and would serve a two-year term (2013-2015), except as noted. Please vote for up to seven candidates.

_____ David Bizot
_____ Wendy Carman
_____ Frank Commiskey (to complete a 2012-2014 term)
_____ Emily Eisbruch
_____ Pete Mooney
_____ Amy Seetoo
_____ Jerry Schulte
_____ Write-in* (name, address, phone)_____

Thanks to Henry Brysk

Many thanks to retiring board member Henry Brysk for his service to the OHMHA Board and to the community.

*If submitting write-in candidates, please make sure they are eligible for board membership (that is, they are current OHMHA members, and you have their permission to submit their names). If you are interested in becoming a board member yourself, please contact any current board member or attend an upcoming meeting.

PROPOSED BUDGET FOR 2013-2014 (see page 6)

_____ Approve _____ Do not approve

HOW TO VOTE

- Drop ballot in OHMHA ballot box at Thurston Ice Cream Social, May 31, 7:00-8:30 pm
- Turn in to Peter Mooney, 3352 Yellowstone, Ann Arbor, MI 48105, by June 1

ORCHARD HILLS ~ MAPLEWOOD HOMEOWNERS ASSOCIATION MEMBERSHIP DUES FOR JUNE 1, 2013 ~ MAY 31, 2014

(Make check for \$20.00 payable to OHMHA ~ additional contributions gratefully accepted.)

NAME _____ TELEPHONE _____

ADDRESS _____ AMOUNT PAID _____

EMAIL ADDRESS _____ ☐ Please remove my name from your email list.

COMMENTS (we welcome suggestions and/or offers to volunteer on OHMHA projects):

Mail or deliver your dues to: Wendy Carman, OHMHA Treasurer, 2340 Georgetown, Ann Arbor 48105

OHMHA BOARD MEMBERS

Peter Mooney	3352 Yellowstone	213-0440	President
Greg Jagst	2080 Yorktown	846-6332	Vice President
Wendy Carman	2340 Georgetown	761-8693	Treasurer
Phil Savage	3304 Bluett	994-6560	Secretary
Anne Karabakal	2405 Bunker Hill	669-2084	Webmaster
Jack Cederquist	2145 Ardenne	665-2282	
Jerry Schulte	3334 Yellowstone	668-2590	
Frank Commiskey	2647 Antietam Ct	369-0992	
David Bizot	3359 Yellowstone Dr	240-888-3295	
Rabia Shafie	3325 Bluett Dr	668-6430	
Amy Seetoo	3111 Cedarbrook	332-0390	
Emily Eisbruch	2561 Bunker Hill	665-0533	Newsletter (eisbruchs@gmail.com)

ELECTED REPRESENTATIVES

John Hieftje (Mayor)		794-6161	jhieftje@a2gov.org
Sally Petersen (Council Member, Ward 2)	2976 Hickory Lane	996-5569	spetersen@a2gov.org.
Jane Lumm (Council Member, Ward 2)	3075 Override Dr.	677-4010	JLumm@a2gov.org

Question: How do I get on the OHMHA email list? Answer: email wjcarman@umich.edu

Question: How do I get on the neighborhood watch list? Answer: email gjagst@aol.com

OHMHA

3352 Yellowstone

Ann Arbor, MI 48105

www.ohmha.org

**Annual General Meeting,
with speaker from AATA,
Friday, May 31 at 7pm at
Thurston School
Teachers' Lounge.**

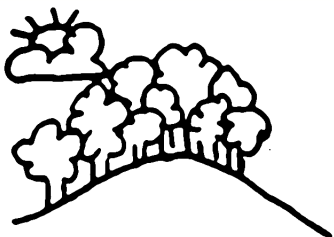

NEWSLETTER

ORCHARD HILLS-MAPLEWOOD HOMEOWNERS ASSOCIATION
